

Mounting Instruction

LQ60 LED II BO MPO

Bemærk:

- Montering af armatur og evt. servicering af LED komponenter, må kun udføres af en kvalificeret person.
- Under hele armatur installationsprocessen skal armaturet altid være i spændingsløs tilstand.
- Sikre dig altid at armaturet er i spændingsløs tilstand, før der åbnes for armaturet ved udførsel af service.
- Ikke-brugerudskiftelig lyskilde: Lyskilden i dette armatur må kun udskiftes af producenten, dennes serviceværksted eller af en tilsvarende kvalificeret person.
- " ESD følsom elektronik " undgå alt unødvendig berøring af LED paneler og LED drivere. ⚡
- Optiske linser samt andre former for optik, gitter og covers, skal altid være monteret når armaturet er i drift.
- Armaturer med DALI driver, skal være tilsluttet en god og aktiv jordforbindelse.

Attention:

- Installation of luminaire and servicing of LED components, may only be performed by an qualified person.
- During the complete luminaire installation process, the luminaire must always be without power.
- Always power off luminaire before opening or accessing any part of the luminaire during service routines.
- Non-user replaceable lightsource: The lightsource contained in this luminaire shall only be replaced by the manufacturer, or his service agent or a similar qualified person.
- " ESD sensitive components " avoid unnecessary touching LED boards and LED drivers. ⚡
- Optical lenses and other forms of optics and grids, must always be mounted when luminaire is in operation.
- Luminaire with DALI driver must have an good active ground/earth connection.

- ① DK: Pakken indholder
GB: Content of package

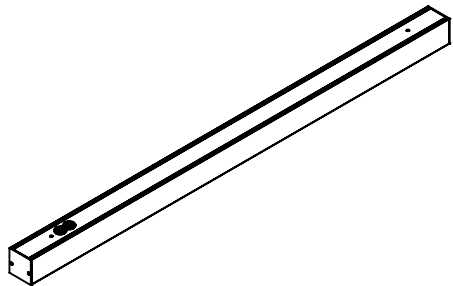

- ③ DK: Afmonter LED afskærmning.
GB: Remove LED optics.

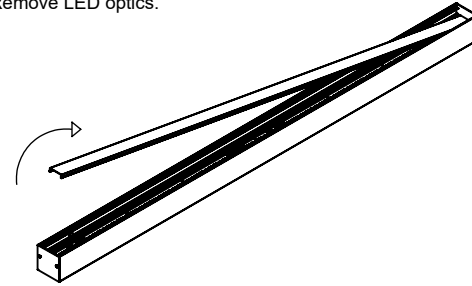

Info

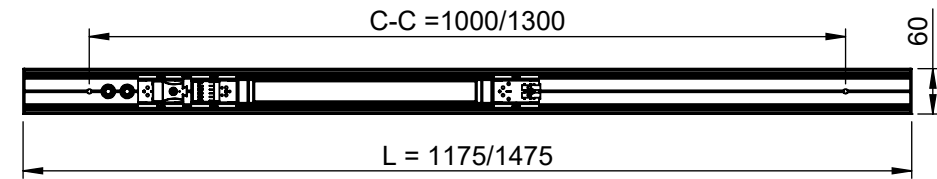

- DK - Kabel indgang.
GB - Cable in.
- DK - Tilslutning.
GB - Connection.



- DK - Hul for loft montage
GB - Hole for ceiling installation
- DK - Intern stik
GB - Internal plug.

- ② DK: Afmonter afskærmning.
GB: Remove front optics.

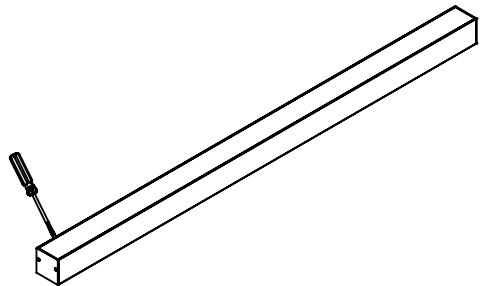

- ④ DK: Afmonter 2 stk. sikkerhedsskruer.
GB: Remove 2 pcs. safety screws.

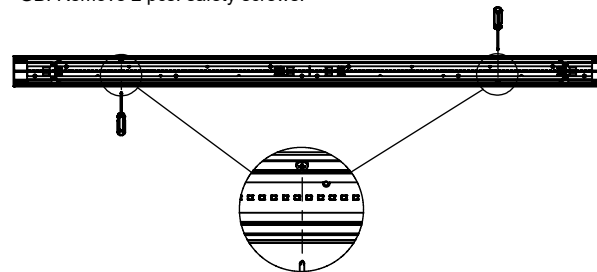

- ⑥ Option
DK: Nedhængt i wire via ophængssæt (86 46 076 474) - ikke inkluderet)
GB: Suspended in wire by suspensionkit (86 46 076 474) - not included)

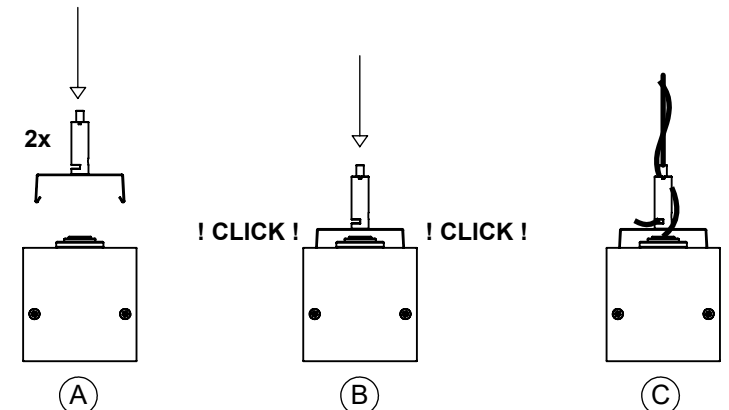

- ⑤ DK: Afmonter LED enheden.
GB: Remove LED unit.
- DK: Frakobel jord
GB: Disconnect ground

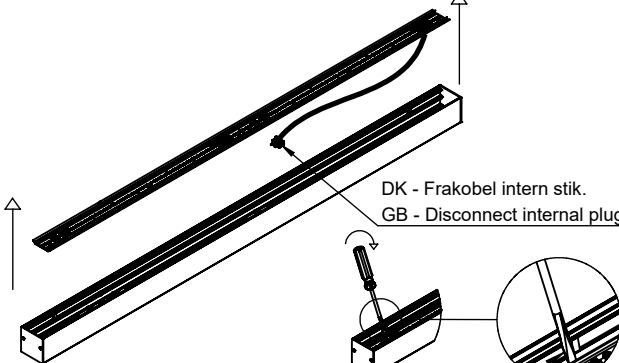

- DK - Frakobel intern stik.
GB - Disconnect internal plug.

- DK: Skruetrækker tæt på fjeder
GB: Screwdriver close to spring